

AN ULLRICH ALUMINIUM COMPANY

PRODUCT GUIDE

LEADING WINDOW
& DOOR SYSTEMS

"Building products beyond the standards"



WINDOWS

FRASER SLIDING WINDOW

48mm Frame	6
65mm Frame	
75mm Frame	
100mm Frame	

FLINDERS SLIDING WINDOW

65mm Frame	8
------------	---

HUDSON DOUBLE-HUNG WINDOW

62mm Frame	10
------------	----

CASUARINA AWNING WINDOW

48mm Frame	12
75mm Frame	
100mm Frame	

WHITSUNDAY AWNING WINDOW

100mm Frame	14
-------------	----

DENNISON CASEMENT WINDOW

48mm Frame	16
75mm Frame	

LINDEMAN CASEMENT WINDOW

100mm Frame	18
-------------	----

JARVIS LOUVRE WINDOW

125mm Frame	20
-------------	----

BEDARRA BIFOLD WINDOW

100mm Frame	22
-------------	----

DOORS

HAMILTON SLIDING DOOR

100mm Frame	26
-------------	----

HAMILTON SLIDING STACKER DOOR

170mm Frame	28
235mm Frame	

HAMILTON SECONDARY GLAZED SLIDING DOOR

165mm Frame	32
-------------	----

MACLEAY SLIDING DOOR

100mm Frame	34
-------------	----

BEDARRA BIFOLD DOOR

100mm Frame	36
-------------	----

ASPEN HINGED DOOR

145mm Frame	38
-------------	----

ADDITIONAL INFORMATION

Compliance & Guarantee	40
Directory	42

+ CONTENTS



WINDOWS

The hollow sill design of our windows helps to achieve maximum weatherability.

All wind load categories are catered for Australia wide.

All Wintec Systems products feature smooth, rounded finishing to prevent possible injury on sharp corners and edges, and catching on window furnishings.

This design also makes for easier and safer maintenance.

Top and bottom sash rails are concealed within the sill and frame and there are no internal projections of transom and sash sections.

Additional options for our windows include: standard or barrel key locking and insect or security screens.

FRASER

SLIDING WINDOW

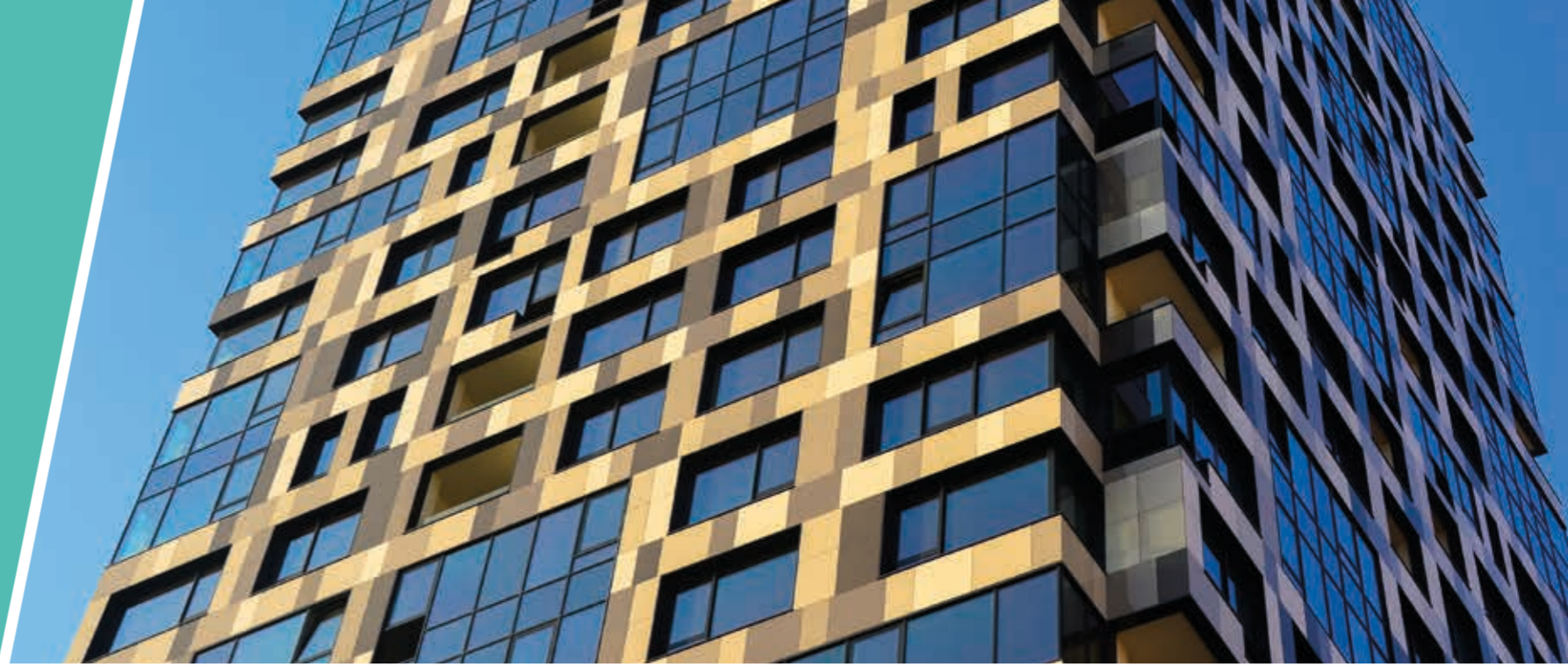

FEATURES AND BENEFITS OF THE FRASER SLIDING WINDOW INCLUDE:

There are no unfinished or exposed edges and no internal projection of transom and sash sections. The top and Bottom sash rails are concealed within the sill and frame.

The sash sits completely inside the frame which resists rolling off the top and bottom sash rail under high wind loads, with increased daylight opening.

Heavy duty double rollers are standard on all wintec sliding windows which last longer and operated smoother than conventional types.

Our handles are also ergonomically designed for ease of use especially for the elderly and disabled. The handles operate in the direction of the sash movement and are available in four colours.

Additional options include:
Multi-position vent locking.

Frame widths available:
48mm, 65mm, 75mm & 100mm
In finned, fin-less and face fix configurations.

PERFORMANCE

STRUCTURAL PERFORMANCE (UP TO)

- + Serviceability Limit State Wind Pressure: 3000Pa max
- + Ultimate Limit State Wind Pressure: 6000Pa max
- + Water Penetration Resistance Pressure: 600Pa max

MAXIMUM RECOMMENDED SIZE (UP TO)

- + Height: 1550mm
- + Height with low light: 2750mm
- + Width: 3000mm

GLAZING - MAXIMUM THICKNESS (UP TO)

- + Single Glazed: 12.38mm
- + Double Glazed: 16mm

ACOUSTICS (UP TO)

- + 48mm Sliding Window: RW (C.Ctr): 31 (0-2)
- + 1016mm Sliding Window: RW (C.Ctr): 33 (-1-2)

48MM SLIDING WINDOW - TOTAL WINDOW AFRC				
	Uw	SHGC	T _w	Air Inf
WAS-001-02 4mm Clear	6.4	0.75	0.78	0.1
WAS-001-06 4mm Grey	6.4	0.59	0.49	0.1
WAS-001-11 6.38mm ComfortPlus Clear	4.5	0.61	0.72	0.1

65MM SLIDING WINDOW - TOTAL WINDOW AFRC				
	Uw	SHGC	T _w	Air Inf
WAS-016-04 6.38mm ComfortPlus Clear	4.6	0.59	0.69	1.0
WAS-016-06 6mm EnergyTech	4.6	0.60	0.69	1.0
WAS-016-10 6mm Clear	6.3	0.70	0.75	1.0

101.60MM SLIDING WINDOW - TOTAL WINDOW AFRC				
	Uw	SHGC	T _w	Air Inf
WAS024-01 6.38mm ComfortPlus Grey	4.9	0.41	0.31	1.0
WAS024-02 6.38mm ComfortPlus Neutral	4.9	0.42	0.46	1.0
WAS024-04 6.38mm ComfortPlus Clear	4.9	0.55	0.64	1.0
WAS024-05 6.38mm Grey Laminate	6.5	0.50	0.33	1.0
WAS024-06 6.38mm Clear Laminate	6.5	0.63	0.69	1.0
WAS024-08 6mm EnergyTech Grey	5.0	0.39	0.31	1.0
WAS024-10 4mm EnergyTech	5.0	0.58	0.65	1.0

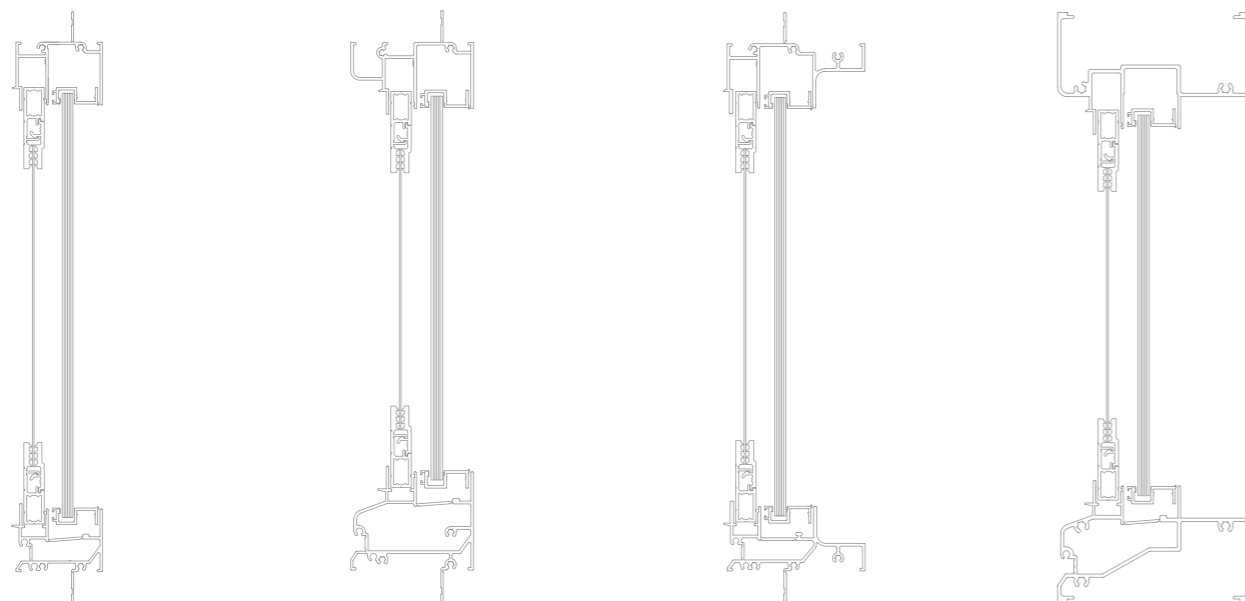

48mm FRAME

65mm FRAME

75mm FRAME

100mm FRAME

CONFIGURATIONS - VIEW FROM OUTSIDE



FLINDERS

DOUBLE GLAZED SLIDING WINDOW



FEATURES AND BENEFITS OF THE FLINDERS SLIDING WINDOW INCLUDE:

Hollow mullion and transom for stability and strength. Heavy duty double rollers for smoother operation and longevity.

No internal projection of transom and sash sections.

Wintec Systems handles are ergonomically designed for ease of use for the elderly and disabled.

The handles operate in the direction of the sash movement and are available in four colours.

Additional options include:
Multi-position vent locking, standard or barrel key locking, insect or security screens.

Frame widths available:
65mm can accommodate 16mm glazing.

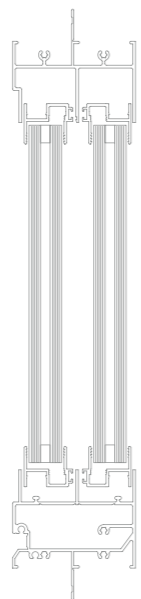

65mm FRAME

PERFORMANCE

STRUCTURAL PERFORMANCE (UP TO)

- + Serviceability Limit State Wind Pressure: 3000Pa max
- + Ultimate Limit State Wind Pressure: 6000Pa max
- + Water Penetration Resistance Pressure: 330Pa max

MAXIMUM RECOMMENDED SIZE (UP TO)

- + Height: 1550mm
- + Height with low light: 2750mm
- + Width: 3000mm

GLAZING MAXIMUM THICKNESS (UP TO):

- + Double Glazed: 16mm

65MM SLIDING WINDOW - TOTAL WINDOW AFRC				
	Uw	SHGC	Tvw	Air Inf
WAS-004-04 4mm Clear/ 8mm Argon / 4mm Clear	3.9	0.63	0.66	0.8
WAS-004-05 4mm Clear/ 8mm Argon / 4mm EnergyTech	3.3	0.59	0.61	0.8
WAS-004-08 4mm Grey/ 8mm Argon / 4mm EnergyTech	3.3	0.42	0.38	0.8

CONFIGURATIONS - VIEW FROM OUTSIDE



HUDSON

DOUBLE HUNG WINDOW



FEATURES AND BENEFITS OF THE HUDSON DOUBLE HUNG WINDOW INCLUDE:

There are two sash types available for this system: Standard and Federation Wide Stile.

The Standard sash incorporates hollow rails for added strength and are flush to the jambs offering clear sight lines.

They also feature built-in extruded handles to both the top and bottom sashes.

Versatile security and insect screens can be installed and removed from inside the building.

The Federation Wide Stile sash replicates the look of timber double hung windows.

Frame widths available: 62mm.

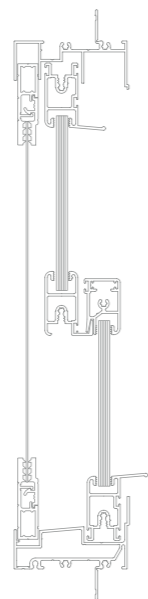

62mm FRAME

PERFORMANCE

STRUCTURAL PERFORMANCE (UP TO)

- + Serviceability Limit State Wind Pressure: 3000Pa max
- + Ultimate Limit State Wind Pressure: 4600Pa max
- + Water Penetration Resistance Pressure: 450Pa max

MAXIMUM RECOMMENDED SIZE (UP TO)

- + Height: 2400mm
- + Height with low light: 3000mm
- + Width: 1200mm

GLAZING MAXIMUM THICKNESS (UP TO)

- + Single Glazed: 6.76mm
- + Double Glazed: 16mm

ACOUSTICS (UP TO)

- + Double Hung Window: RW (C:Ctr): 31 (-1-2)

DOUBLE HUNG WINDOW - TOTAL WINDOW AFRC

	Uw	SHGC	Tvw	Air Inf
WAS-012-03 5mm Clear	6.3	0.71	0.75	3.6
WAS-012-05 6.38mm Clear Laminate	6.2	0.68	0.75	3.6
WAS-012-11 6.38mm ComfortPlus Clear	4.5	0.59	0.69	3.6

CONFIGURATIONS - VIEW FROM OUTSIDE



CASUARINA

AWNING WINDOW



FEATURES AND BENEFITS OF THE CASUARINA AWNING WINDOW INCLUDE:

The Casuarina Awning Window is a top hung system with hollow mullion and stile sections to add strength and security.

The additional use of Q'lon seals with this system also improves energy, weather and acoustic performance.

It can also accommodate friction stays and chain winder options. Multiple bays can be added using a standard mullion.

The design includes multiple stiles to accommodate several glass thicknesses

Options available include: restricted opening, standard or barrel key locking, insect or security screens.

Frame widths available: 48mm, 75mm, and 100mm

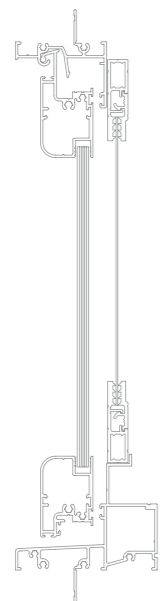

48mm FRAME

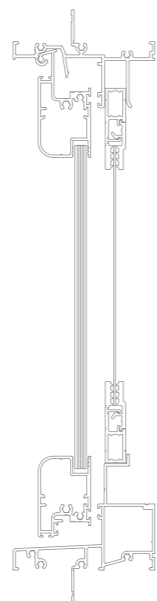

75mm FRAME

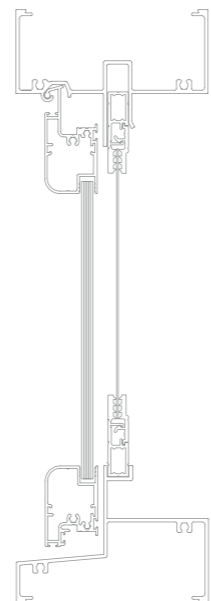

100mm FRAME

PERFORMANCE

STRUCTURAL PERFORMANCE (UP TO)

- + Serviceability Limit State Wind Pressure: 1000Pa max
- + Ultimate Limit State Wind Pressure: 3500Pa max
- + Water Penetration Resistance Pressure: 1000Pa max

MAXIMUM RECOMMENDED SIZE (UP TO)

- + Height: 1550mm
- + Height with low light: 2750mm
- + Width: 1200mm (sash width)

GLAZING MAXIMUM THICKNESS (UP TO)

- + Single Glazed: 6.76mm
- + Double Glazed: 22mm

ACOUSTICS (UP TO)

- + 48mm Awning Window: RW (C.Ctr): 32 (0-1)
- + 1016mm Awning Window: RW (C.Ctr): 35 (-1-3)

48MM SINGLE GLAZED - TOTAL WINDOW AFRC

	Uw	SHGC	Tvw	Air Inf
WAS-011-05 5mm Clear	6.4	0.62	0.65	0.3
WAS-011-04 4mm Grey	6.4	0.49	0.40	0.3
WAS-011-15 6.38mm ComfortPlus Clear	4.7	0.52	0.60	0.3

48MM DOUBLE GLAZED - TOTAL WINDOW AFRC

	Uw	SHGC	Tvw	Air Inf
WAS-015-05 5mm Clear/ 12mm Argon / 5mm Clear	3.9	0.54	0.57	0
WAS-015-07 4mm Clear/ 12mm Argon / 6mm EnergyTech	3.3	0.53	0.53	0
WAS-015-20 6.38mm ComfortPlus Clear / 12mm Argon/ 4mm Clear	3.3	0.46	0.53	0

CONFIGURATIONS - VIEW FROM OUTSIDE

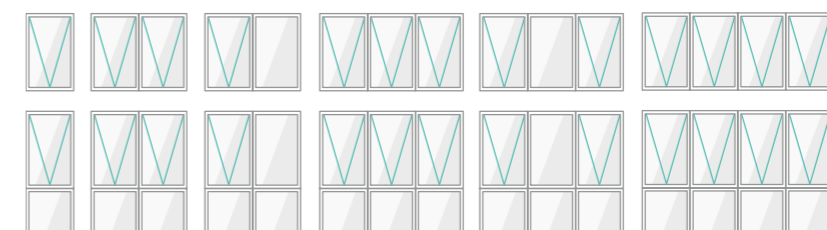

WHITSUNDAY

AWNING WINDOW



FEATURES AND BENEFITS OF THE WHITSUNDAY AWNING WINDOW INCLUDE:

The Wintec Systems Whitsunday 100mm Awning Window is one for extremes! It boasts an extreme size with very large opening sashes.

It's also excellent in extreme weather as its multi-point locking feature adds extra security in high wind areas.

Additional options include: restricted opening, standard or barrel key locking, insect or security screens.

Frame widths available: 100mm

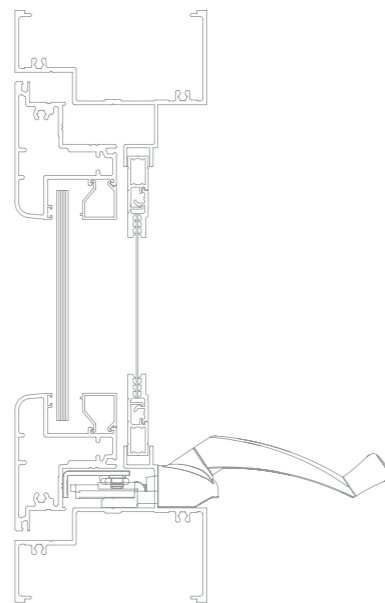

100mm FRAME

PERFORMANCE

STRUCTURAL PERFORMANCE (UP TO)

- + Serviceability Limit State Wind Pressure: 3000Pa max
- + Ultimate Limit State Wind Pressure: 6100Pa max
- + Water Penetration Resistance Pressure: 450Pa max

MAXIMUM RECOMMENDED SIZE (UP TO)

- + Height: 2200mm
- + Height with low light: 2750mm
- + Width: 1500mm (sash width)

GLAZING MAXIMUM THICKNESS (UP TO)

- + Single Glazed: 12.76mm
- + Double Glazed: 24mm

ACOUSTICS (UP TO)

- + 1016mm Awning Window: RW (C:Ctr): 34 (-1:-2)

SINGLE GLAZED - TOTAL WINDOW AFRC

	Uw	SHGC	T _w	Air Inf
WAS-017-06 6.38mm Clear Laminate	6.4	0.41	0.41	1.0
WAS-017-05 6.3mm Grey Laminat	6.4	0.33	0.19	1.0
WAS-017-04 6.38mm ComfortPlus Clear	5.6	0.37	0.38	1.0

DOUBLE GLAZED - TOTAL WINDOW AFRC

	Uw	SHGC	T _w	Air Inf
WAS-018-02 Viridian LightBridge Clear SO 5/14/5	4.2	0.31	0.36	1.0
WAS-018-05 6mm Clear/ 12mm Argon / 6mm Clear	4.7	0.37	0.36	1.0
WAS-018-07 6mm Clear/ 12mm Argon/ 6mm EnergyTech	4.3	0.36	0.34	1.0

CONFIGURATIONS - VIEW FROM OUTSIDE

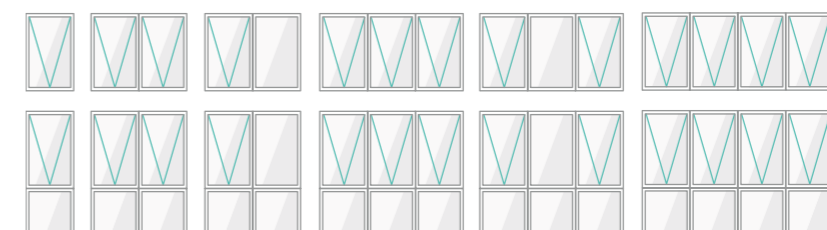

DENNISON

CASEMENT WINDOW



FEATURES AND BENEFITS OF THE DENNISON CASEMENT WINDOW INCLUDE:

The Dennison Casement Window is a stayed system with hollow mullion and stile sections to add strength and security.

The additional use of Q'lon seals with this system also improves energy, weather and acoustic performance.

Multiple bays can be added using a standard mullion.

Frame widths available: 48mm, 75mm



48mm FRAME

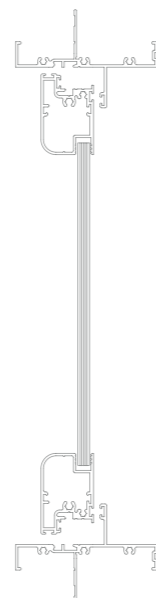

75mm FRAME

PERFORMANCE

STRUCTURAL PERFORMANCE (UP TO)

- + Serviceability Limit State Wind Pressure: 1800Pa max
- + Ultimate Limit State Wind Pressure: 2300Pa max
- + Water Penetration Resistance Pressure: 600Pa max

MAXIMUM RECOMMENDED SIZE (UP TO)

- + Height: 1250mm
- + Height with low light: 2000mm
- + Width: 600mm (sash width)

GLAZING MAXIMUM THICKNESS (UP TO)

- + Single Glazed: 6.76mm
- + Double Glazed: 22mm

ACOUSTICS (UP TO)

- + 48mm Casement Window: RW (C:Ctr): 32 (0:-1)
- + 101.6mm Casement Window: RW (C:Ctr): 35 (-1:-3)

48MM DOUBLE GLAZED - TOTAL WINDOW AFRC				
	Uw	SHGC	Tvw	Air Inf
WAS-008-01 4mm Clear/ 8mm Air/ 4mm Clear	4.0	0.56	0.58	0.4
WAS-008-02 4mm Evergreen/ 8mm Air/ 4mm Air	4.0	0.35	0.48	0.4
WAS-008-03 4mm Evergreen/ 10mm Air/ 4mm Energy Advantage	3.4	0.31	0.45	0.4

CONFIGURATIONS - VIEW FROM OUTSIDE

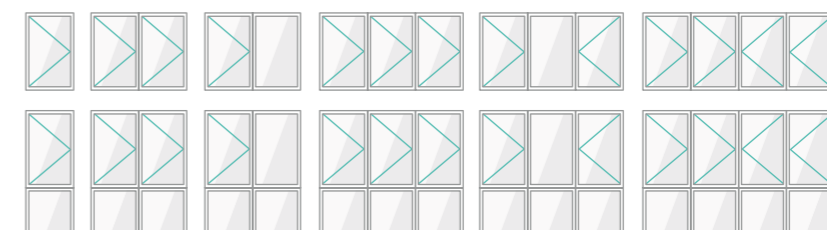

LINDEMAN 100

CASEMENT WINDOW



FEATURES AND BENEFITS OF THE LINDEMAN CASEMENT WINDOW INCLUDE:

The Wintec Systems Lindeman 100mm Casement Window is one for extremes! It boasts an extreme size with very large opening sashes.

It's also excellent in extreme weather as its multi-point locking feature adds extra security in high wind areas.

Additional options include: restricted opening, standard or barrel key locking, insect or security screens.

Frame widths available: 100mm

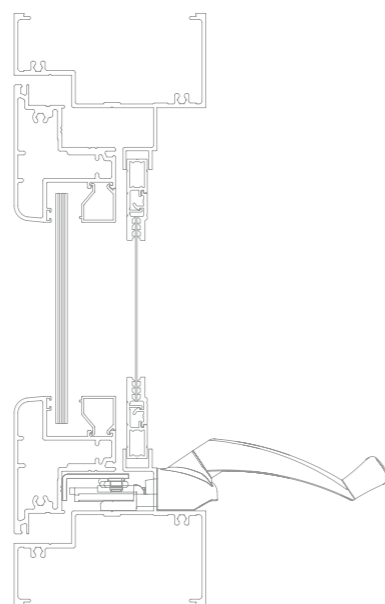

100mm FRAME

PERFORMANCE

STRUCTURAL PERFORMANCE (UP TO)

- + Serviceability Limit State Wind Pressure: 3000Pa max
- + Ultimate Limit State Wind Pressure: 6700Pa max
- + Water Penetration Resistance Pressure: 635Pa max

MAXIMUM RECOMMENDED SIZE (UP TO)

- + Height: 2200mm
- + Height with low light: 2750mm
- + Width: 1000mm (sash width)

GLAZING MAXIMUM THICKNESS (UP TO)

- + Single Glazed: 12.76mm
- + Double Glazed: 24mm

ACOUSTICS (UP TO)

- + 1016mm Casement Window: RW (C:Ctr): 34 (-1-2)

SINGLE GLAZED - TOTAL WINDOW AFRC

	Uw	SHGC	T _w	Air Inf
WAS-019-06 6.38mm Clear Laminate	6.3	0.41	0.41	1.0
WAS-019-05 6.3mm Grey Laminat	6.3	0.33	0.19	1.0
WAS-019-04 6.38mm ComfortPlus Clear	5.4	0.36	0.38	1.0

DOUBLE GLAZED - TOTAL WINDOW AFRC

	Uw	SHGC	T _w	Air Inf
WAS-020-02 Viridian LightBridge Clear SO 5/14/5	4.2	0.31	0.36	1.0
WAS-020-05 6mm Clear/ 12mm Argon / 6mm Clear	4.7	0.37	0.36	1.0
WAS-020-07 6mm Clear/ 12mm Argon/ 6mm EnergyTech	4.3	0.35	0.34	1.0

CONFIGURATIONS - VIEW FROM OUTSIDE

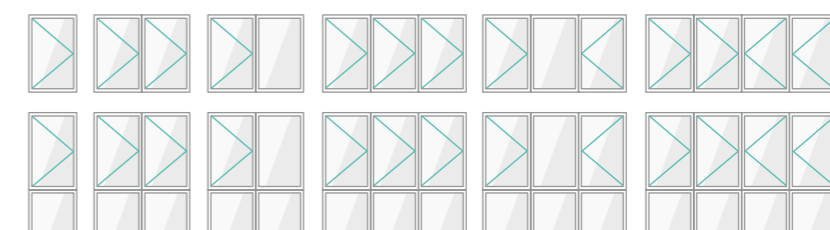

JARVIS 125

LOUVRE WINDOW



FEATURES AND BENEFITS OF THE JARVIS LOUVRE WINDOW INCLUDE:

The Jarvis louvre window design allows for multiple banks of louvres within the same perimeter frame.

It accommodates glass, aluminium or timber blades and features a built-in insect or security screen track.

This is an excellent product for ventilation.

Available operating systems include: remote control, handle locking bars, and manual operation.

The Jarvis Louvre can be coupled with various other Wintec Systems products.

Frame widths available: 125mm.

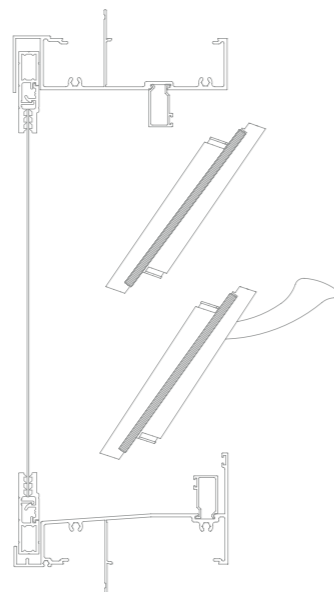

125mm FRAME

PERFORMANCE

STRUCTURAL PERFORMANCE (UP TO)

- + Serviceability Limit State Wind Pressure: 1800Pa max
- + Ultimate Limit State Wind Pressure: 3000Pa max
- + Water Penetration Resistance Pressure: 200Pa max

MAXIMUM RECOMMENDED SIZE (UP TO)

- + Height: 2700mm
- + Width: 900mm (sash width)

GLAZING THICKNESS

- + Single Glazed: 6mm

TEST REPORT SUMMARY - LOUVRE WINDOW 2185 X 752 L

TEST 0186 Performed 16th May 2018

Construction	
Head	WALW171
Sill	WALW170
Jamb	WALW172
Bead	WAAW134
Seals	SC31 Top and Bottom Beads
Glass	6mm Float Louvre Blades
Gallery	Breezeway Altair Louvre Gallery

TEST	RESULTS	HOUSING SUITABILITY	
		General	Corner
Deflection	N/A	N/A	N/A
Operating Force	N/A		
Air Infiltration	HIGH		
		Non-Exposed	Exposed
Water Penetration Resistance	200Pa	N4/C2	C2
Ultimate Strength		General	Corner
Positive	2833Pa	N4/C2	N3/C1
Negative	2727Pa		

*note: For further details, please refer to the complete test report.

CONFIGURATIONS - VIEW FROM OUTSIDE



BEDARRA 100

BI-FOLD WINDOW



FEATURES AND BENEFITS OF THE BEDARRA 100mm BI-FOLD WINDOW INCLUDE:

The Bedarra 100mm Bifold Window design utilises large panels, this insures more uninterrupted views without sacrificing strength and safety.

Quality marine grade stainless steel hardware is used to ensure product longevity and performance in the harshest of conditions, making it ideal for coastal and exposed locations.

The sill is reversible allowing for inward and/or outward opening.

With a modern design that utilises quality seals, the Bedarra will meet the highest demands for energy efficiency and weather performance in today's market.

Additional options include: multi-point locking hardware for better security and a dust seal on head track to reduce wear and corrosion.

Frame widths available: 100mm

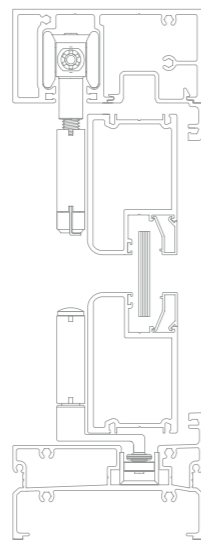

100mm FRAME

PERFORMANCE

STRUCTURAL PERFORMANCE (UP TO)

- + Serviceability Limit State Wind Pressure: 2000Pa max
- + Ultimate Limit State Wind Pressure: 4000Pa max
- + Water Penetration Resistance Pressure: 330Pa max

MAXIMUM RECOMMENDED SIZE (UP TO)

- + Height: 1500mm
- + Height (with lowlite): 2400mm
- + Width: 600mm (sash width)
- + Weight: 20kg
- + 4 sashes

GLAZING MAXIMUM THICKNESS (UP TO)

- + Single Glazed: 10.76mm
- + Double Glazed: 22mm

ACOUSTICS (UP TO)

- + Bi-fold window: RW (C:Ctr): up to 33 (-1:-2)

SINGLE GLAZED - TOTAL WINDOW AFRC

	Uw	SHGC	T _{vw}	Air Inf
6.38mm Clear Laminate	5.9	0.57	0.61	1.0
6.38mm Grey Laminate	5.9	0.45	0.29	1.0
6.38mm ComfortPlus Clear	4.4	0.49	0.57	1.0

DOUBLE GLAZED - TOTAL WINDOW AFRC

	Uw	SHGC	T _{vw}	Air Inf
4mm Clear / 8mm Argon / 4mm Clear	3.9	0.54	0.56	1.0
4mm Clear / 8mm Argon / 4mm EnergyTech	3.4	0.51	0.52	1.0
Viridian LightBridge Clear SO 4/8/4	3.2	0.42	0.55	1.0

*note: energy efficient ratings are an estimate only.

CONFIGURATIONS - VIEW FROM OUTSIDE

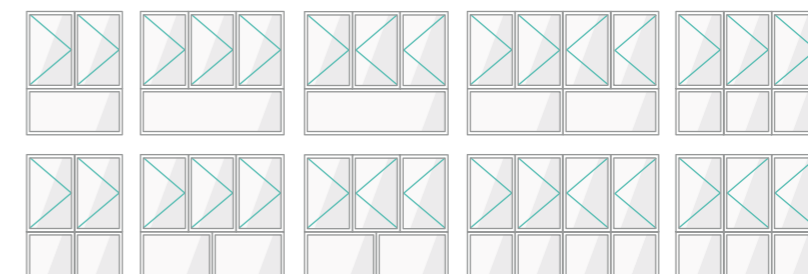



DOORS

The hollow sill, mullions and stiles give added strength and security. The design of our doors helps to achieve maximum weatherability. All wind load categories are catered for Australia wide.

All Wintec Systems products feature smooth, rounded finishing to prevent possible injury on sharp corners and

edges, and catching on door furnishings. This design also makes for easier and safer maintenance.

Top and bottom sash rails are concealed within the sill and frame.

Additional options for our doors include: standard or barrel key locking and insect or security screens.

HAMILTON 100

SLIDING DOOR



FEATURES AND BENEFITS OF THE HAMILTON 100mm SLIDING DOOR INCLUDE:

Large doors are fitted with heavy duty double rollers. All sliding door wheels have stainless steel bearings.

A commercial lock stile is available for architectural hardware applications.

A low profile sill is available for nursing home applications as well as an Australian standard AS1428 compliant sill.

The Hamilton 100mm sliding door can be coupled to various other Wintec Systems products.

Additional options include: insect or security screens as well as double glazing.

Frame widths available: 100mm.

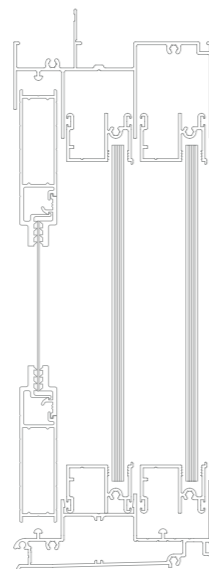

100mm FRAME

PERFORMANCE

STRUCTURAL PERFORMANCE (UP TO)

- + Serviceability Limit State Wind Pressure: 3000Pa max
- + Ultimate Limit State Wind Pressure: 6000Pa max
- + Water Penetration Resistance Pressure: 600Pa max

MAXIMUM RECOMMENDED SIZE (UP TO)

- + Height: 2700mm
- + Width: 1500mm (sash width)

GLAZING MAXIMUM THICKNESS (UP TO)

- + Single Glazed: 10.76mm
- + Double Glazed: 22mm

ACOUSTICS (UP TO)

- + 105mm Sliding Door: RW (C:Ctr): up to 35 (-2;-3)

SINGLE GLAZED - TOTAL WINDOW AFRC

	Uw	SHGC	T _w	Air Inf
WAS-005-01 6.38mm Clear Laminate	6.0	0.72	0.78	0.8
WAS-005-02 6.38mm Grey Laminate	6.0	0.55	0.39	0.8
WAS-005-06 6.38mm ComfortPlus Clear	4.2	0.60	0.72	0.8

DOUBLE GLAZED - TOTAL WINDOW AFRC

	Uw	SHGC	T _w	Air Inf
WAS-013-05 5mm Clear / 12mm Argon / 5mm Clear	3.6	0.62	0.67	1.5
WAS-013-07 4mm Clear / 12mm Argon / 6mm EnergyTech	2.9	0.61	0.63	1.5
WAS-013-15 Viridian LightBridge Clear SO 5/12/5	2.7	0.50	0.67	1.5

CONFIGURATIONS - VIEW FROM OUTSIDE



HAMILTON 170

SLIDING STACKER DOOR



FEATURES AND BENEFITS OF THE HAMILTON 170mm SLIDING DOOR INCLUDE:

The Hamilton 170mm sliding door is available in two sill options. The first is a low profile 70mm and the second is a low profile 45mm.

The sill is hollow, with a built in baffle for better water, air and acoustic properties.

This low rail to sill design allows for stronger glass support and the large doors are fitted with double rollers for heavy duty use.

The Hamilton 170mm 2/3 opening design optimises wide open spaces

without intruding into living or patio areas. It can also be flush fitted with drainage underneath the external decking.

Additional options include insect or security screens as well as double glazing. A commercial lock stile is also available for architectural hardware applications.

Frame widths available: 170mm.

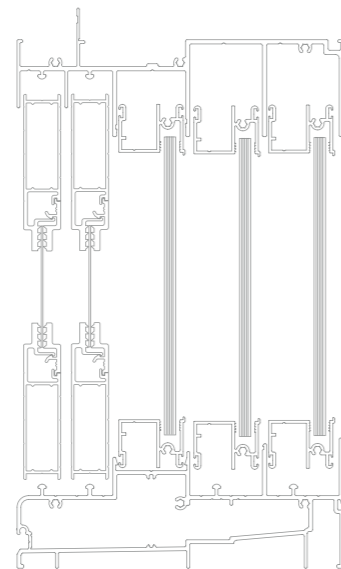

170mm FRAME

PERFORMANCE

STRUCTURAL PERFORMANCE (UP TO)

- + Serviceability Limit State Wind Pressure: 3000Pa max
- + Ultimate Limit State Wind Pressure: 3300Pa max
- + Water Penetration Resistance Pressure: 450Pa max

MAXIMUM RECOMMENDED SIZE (UP TO)

- + Height: 2700mm
- + Width: 1500mm (sash width)

GLAZING MAXIMUM THICKNESS (UP TO)

- + Single Glazed: 10.76mm
- + Double Glazed: 22mm

ACOUSTICS (UP TO)

- + Sliding Door: RW (C:Ctr): Up to 35 (-2:-3)

SINGLE GLAZED - TOTAL WINDOW AFRC

	Uw	SHGC	T _{vw}	Air Inf
WAS-005-01 6.38mm Clear Laminate	6.0	0.72	0.78	0.8
WAS-005-02 6.38mm Grey Laminate	6.0	0.55	0.39	0.8
WAS-005-06 6.38mm ComfortPlus Clear	4.2	0.60	0.72	0.8

DOUBLE GLAZED - TOTAL WINDOW AFRC

	Uw	SHGC	T _{vw}	Air Inf
WAS-013-05 5mm Clear / 12mm Argon / 5mm Clear	3.6	0.62	0.67	15
WAS-013-07 4mm Clear / 12mm Argon / 6mm EnergyTech	2.9	0.61	0.63	15
WAS-013-15 Viridian LightBridge Clear SO 5/12/5	2.7	0.50	0.67	15

CONFIGURATIONS - VIEW FROM OUTSIDE



HAMILTON 235

SLIDING STACKER DOOR



FEATURES AND BENEFITS OF THE HAMILTON 235mm SLIDING DOOR INCLUDE::

The Hamilton 235mm 3/4 opening design enables you to enjoy wide open spaces without intruding into living or patio areas.

The low rail to sill feature allows for stronger glass support and its large doors are fitted with double rollers for heavy duty use.

It can also be flush fitted with drainage underneath the external decking.

A commercial lock stile is available for architectural hardware applications.

Additional options include: insect or security screens with add-on tracks as well as double glazing.

Frame widths available: 235mm

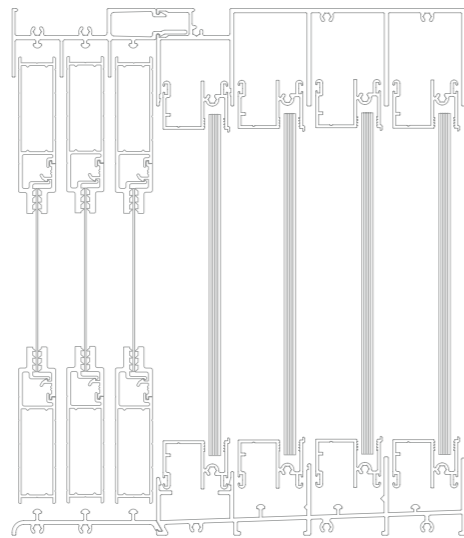

235mm FRAME

PERFORMANCE

STRUCTURAL PERFORMANCE (UP TO)

- + Serviceability Limit State Wind Pressure: 3000Pa max
- + Ultimate Limit State Wind Pressure: 6000Pa max
- + Water Penetration Resistance Pressure: 300Pa max

MAXIMUM RECOMMENDED SIZE (UP TO)

- + Height: 2700mm
- + Width: 1500mm (sash width)

GLAZING MAXIMUM THICKNESS (UP TO)

- + Single Glazed: 10.76mm
- + Double Glazed: 22mm

ACOUSTICS (UP TO)

- + Sliding Door: RW (C:Ctr): Up to 35 (-2:-3)

SINGLE GLAZED - TOTAL WINDOW AFRC

	Uw	SHGC	T _{vw}	Air Inf
WAS-005-01 6.38mm Clear Laminate	6.0	0.72	0.78	0.8
WAS-005-02 6.38mm Grey Laminate	6.0	0.55	0.39	0.8
WAS-005-06 6.38mm ComfortPlus Clear	4.2	0.60	0.72	0.8

DOUBLE GLAZED - TOTAL WINDOW AFRC

	Uw	SHGC	T _{vw}	Air Inf
WAS-013-05 5mm Clear / 12mm Argon / 5mm Clear	3.6	0.62	0.67	15
WAS-013-07 4mm Clear / 12mm Argon / 6mm EnergyTech	2.9	0.61	0.63	15
WAS-013-15 Viridian LightBridge Clear SO 5/12/5	2.7	0.50	0.67	15

CONFIGURATIONS - VIEW FROM OUTSIDE



HAMILTON 165

SECONDARY GLAZED SLIDING DOOR



FEATURES AND BENEFITS OF THE HAMILTON 165mm SLIDING DOOR INCLUDE:

The Hamilton 165mm is a high performance four track multi functional sliding door.

Its low rail to sill design allows for stronger glass support while its hollow sill with built in baffle makes for better water, air and acoustic properties.

The large sliding doors are fitted with double rollers for heavy duty use.

A commercial lock stile is available for architectural hardware applications.

Additional options include: 4 track sliding door or secondary glazed sliding door.

Frame widths available: 165mm.

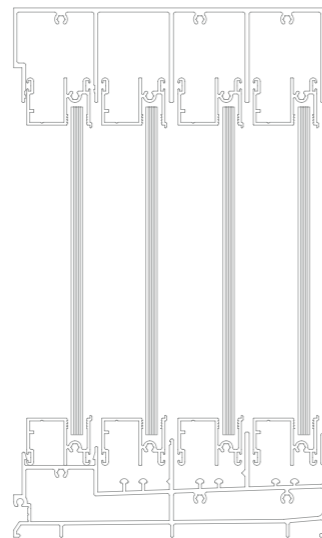

165mm FRAME

PERFORMANCE

STRUCTURAL PERFORMANCE (UP TO)

- + Serviceability Limit State Wind Pressure: 3000Pa max
- + Ultimate Limit State Wind Pressure: 6000Pa max
- + Water Penetration Resistance Pressure: 450Pa max

MAXIMUM RECOMMENDED SIZE (UP TO)

- + Height: 2700mm
- + Width: 1500mm (sash width)

GLAZING MAXIMUM THICKNESS (UP TO)

- + Single Glazed: 10.76mm
- + Double Glazed: 22mm

ACOUSTICS (UP TO)

- + Sliding Door: RW (C:Ctr): Up to 47 (-1:-7)

SINGLE GLAZED - TOTAL WINDOW AFRC

	Uw	SHGC	T _{vw}	Air Inf
WAS-005-01 6.38mm Clear Laminate	6.0	0.72	0.78	0.8
WAS-005-02 6.38mm Grey Laminate	6.0	0.55	0.39	0.8
WAS-005-06 6.38mm ComfortPlus Clear	4.2	0.60	0.72	0.8

DOUBLE GLAZED - TOTAL WINDOW AFRC

	Uw	SHGC	T _{vw}	Air Inf
WAS-013-05 5mm Clear / 12mm Argon / 5mm Clear	3.6	0.62	0.67	15
WAS-013-07 4mm Clear / 12mm Argon / 6mm EnergyTech	2.9	0.61	0.63	15
WAS-013-15 Viridian LightBridge Clear SO 5/12/5	2.7	0.50	0.67	15

CONFIGURATIONS - VIEW FROM OUTSIDE



MACLEAY 100

SLIDING DOOR

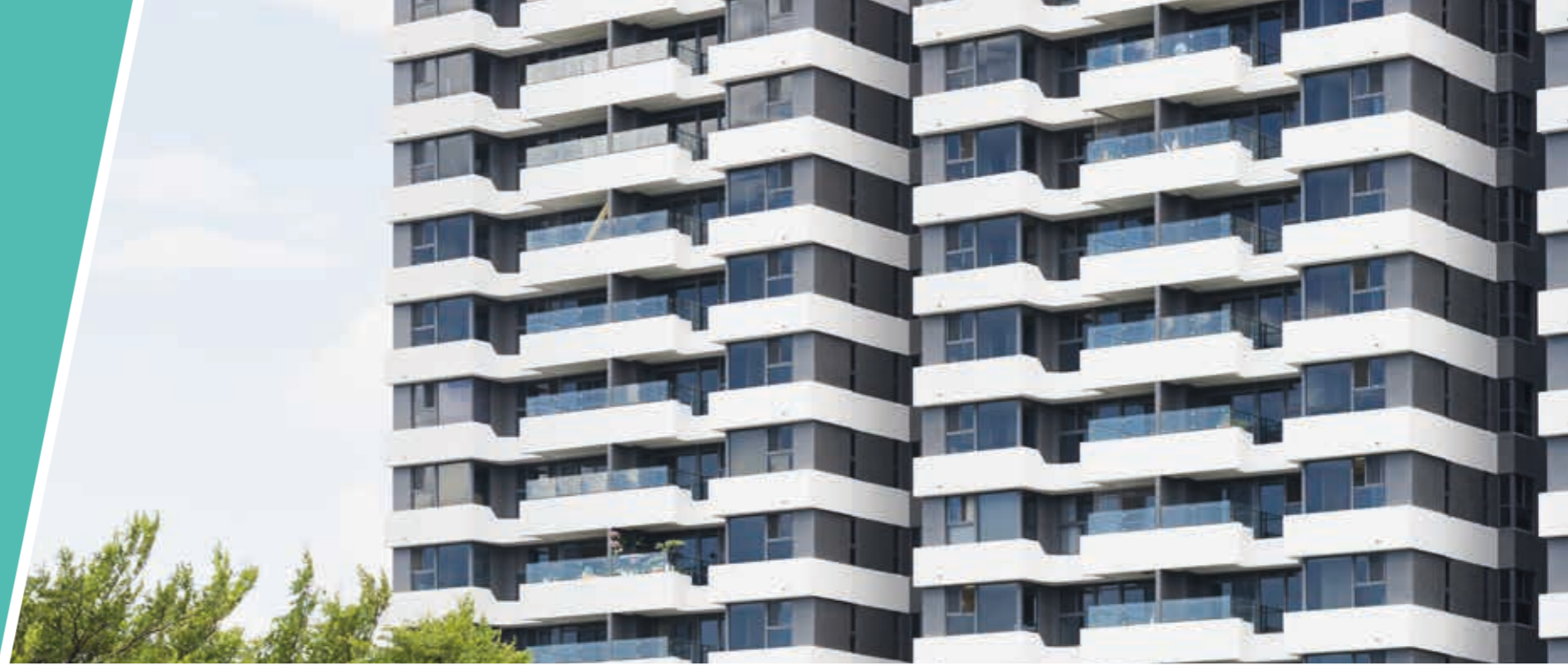

FEATURES AND BENEFITS OF THE MACLEAY 100mm SLIDING DOOR INCLUDE:

Architects and engineers working on projects in cyclonic regions of Australia require higher performing window and door products. The Macleay sliding door is a product born from this necessity.

The upmost strength and increased noise reduction efficiency is obtained through the use of large interlocking hollow sections and heavier gauge wall sections throughout.

Wind load testing above 300Km/hr has proven the Macleay as one of the strongest sliding doors on the market.

Size and strength matter, and with the Macleay sliding door, heights above 3 metres are now possible.

Frame widths available: 100mm

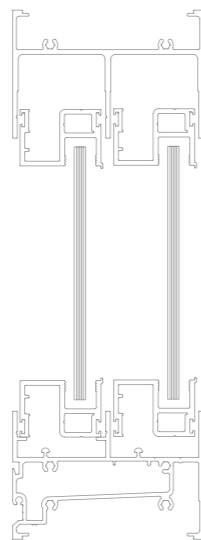

100mm FRAME

PERFORMANCE

STRUCTURAL PERFORMANCE (UP TO)

- + Serviceability Limit State Wind Pressure: 3500Pa max
- + Ultimate Limit State Wind Pressure: 8000Pa max
- + Water Penetration Resistance Pressure: 500Pa max

MAXIMUM RECOMMENDED SIZE (UP TO)

- + Height: 3200mm
- + Width: 1800mm (sash width)

GLAZING MAXIMUM THICKNESS (UP TO)

- + Single Glazed: 10.76mm

ACOUSTICS (UP TO)

- + 1016mm Sliding Door: RW (C.Ctr): up to 34 (-1-3)

SINGLE GLAZED - TOTAL WINDOW AFRC

	Uw	SHGC	T _w	Air Inf
6.38mm Clear Laminate	6.0	0.72	0.78	0.8
6.38mm Grey Laminate	6.0	0.55	0.39	0.8
6.38mm ComfortPlus Clear	4.2	0.60	0.72	0.8

DOUBLE GLAZED - TOTAL WINDOW AFRC

	Uw	SHGC	T _w	Air Inf
5mm Clear / 12mm Argon / 5mm Clear	3.6	0.62	0.67	15
4mm Clear / 12mm Argon / 6mm EnergyTech	2.9	0.61	0.63	15
Viridian LightBridge Clear 50 5/12/5	2.7	0.50	0.67	15

*note: energy efficient ratings are an estimate only.

CONFIGURATIONS - VIEW FROM OUTSIDE



BEDARRA 100

BI-FOLD DOOR



FEATURES AND BENEFITS OF THE BEDARRA 100mm BI-FOLD DOOR INCLUDE:

The Bedarra 100mm Bifold Door features large panels, this ensures more uninterrupted views without sacrificing strength and safety.

Quality marine grade stainless steel hardware is used to ensure product longevity and performance in the harshest of conditions.

Utilising quality seals, the Bedarra will meet the highest demands for energy efficiency and weather performance in today's market.

The sill is reversible allowing for inward and/or outward opening.

Additional features include: multi-point locking hardware for better security, and a dust seal on head tracks reducing wear and corrosion. It is also available in a low profile sill for easy access applications.

Frame widths available: 100mm.

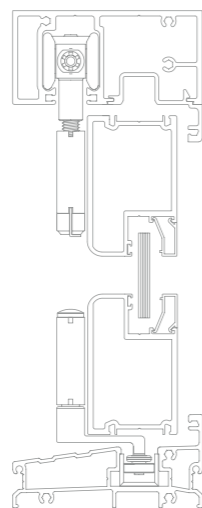

100mm FRAME

PERFORMANCE

STRUCTURAL PERFORMANCE (UP TO)

- + Serviceability Limit State Wind Pressure: 1500Pa max
- + Ultimate Limit State Wind Pressure: 4000Pa max
- + Water Penetration Resistance Pressure: 330Pa max

MAXIMUM RECOMMENDED SIZE (UP TO)

- + Height: 3000mm
- + Width: 1000mm (sash width)
- + Weight: 60kg

GLAZING MAXIMUM THICKNESS (UP TO)

- + Single Glazed: 10.76mm
- + Double Glazed: 22mm

ACOUSTICS (UP TO)

- + Bi-fold Door: RW (C:Ctr): up to 33 (-1-2)

SINGLE GLAZED - TOTAL WINDOW AFRC

	Uw	SHGC	Tvw	Air Inf
WAS-021-06 6.38mm Clear Laminate	5.9	0.57	0.61	1.0
WAS-021-05 6.38mm Grey Laminate	5.9	0.45	0.29	1.0
WAS-021-04 6.38mm ComfortPlus Clear	4.4	0.49	0.57	1.0

DOUBLE GLAZED - TOTAL WINDOW AFRC

	Uw	SHGC	Tvw	Air Inf
WAS-022-04 4mm Clear/ 8mm Argon/ 4mm Clear	3.9	0.54	0.56	1.0
WAS-022-06 4mm Clear/ 8mm Argon/ 4mm EnergyTech	3.4	0.51	0.52	1.0
WAS-022-01 Viridian LightBridge Clear SO 4/8/4	3.2	0.42	0.55	1.0

CONFIGURATIONS - VIEW FROM OUTSIDE

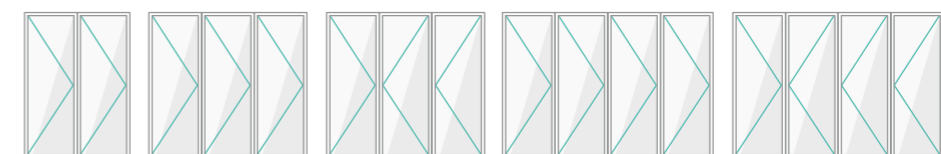

ASPEN 145

HINGED DOOR



FEATURES AND BENEFITS OF THE ASPEN HINGED DOOR INCLUDE:

Strong hollow rails, stiles and mid rails give this hinged door the edge in strength and serviceability. The hollow sill also feature an efficient self draining system for standard aluminium or timber door sashes.

Unique "Z" seals and Q'lon seals used for the head, sill and stiles provide excellent sealing from the weather and guarantee air tightness, noise and energy efficiency. Doors can be opened inwards as well as outwards.

The open in door features a sloped sill for better wheelchair access and water run-off and its double rebate jambs are suited for security doors.

Additional options for both hinged doors include insect or security screens.

Frame widths available: 145mm.

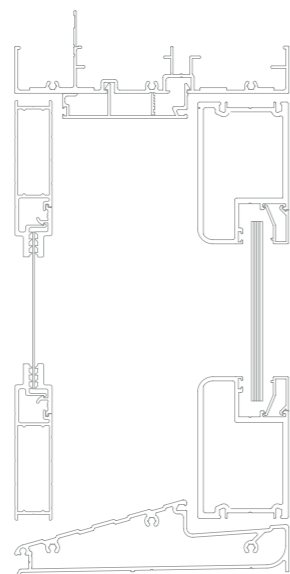

145mm FRAME

PERFORMANCE

STRUCTURAL PERFORMANCE (UP TO)

- + Serviceability Limit State Wind Pressure: 1800Pa max
- + Ultimate Limit State Wind Pressure: 4300Pa max
- + Water Penetration Resistance Pressure: 150Pa max

MAXIMUM RECOMMENDED SIZE (UP TO)

- + Height: 2700mm
- + Width: 1000mm (sash width)

GLAZING MAXIMUM THICKNESS (UP TO)

- + Single Glazed: 12.76mm
- + Double Glazed: 16mm

ACOUSTICS (UP TO)

- + Hinged Door: RW (C:Ctr): up to 33 (-1:-2)

SINGLE GLAZED - TOTAL WINDOW AFRC

	Uw	SHGC	Tvw	Air Inf
WAS-023-06 6.38mm Clear Laminate	5.8	0.56	0.61	1.0
WAS-023-05 6.38mm Grey Laminate	5.8	0.44	0.29	1.0
WAS-023-04 6.38mm ComfortPlus Clear	4.3	0.49	0.57	1.0

CONFIGURATIONS - VIEW FROM OUTSIDE

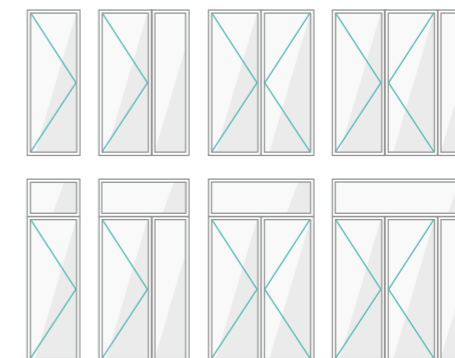



ADDITIONAL INFORMATION

COMPLIANCE

Wintec Systems is a member of the Australian Window Association and as such, conforms to an Industry code of conduct designed to protect consumers.

Wintec Systems is inspected by third party NATA accredited auditors to validate that the window and door products examined have been manufactured to the relevant Australian standards and the legislation requirements of the Australian building code.

SEVEN YEAR GUARANTEE

This guarantee is in addition to all other rights and remedies in respect of these products which you are entitled to under the trade practises act and other similar state and territory laws and should be read in addition to any guarantees provided specific to the company of issue.

Wintec Systems are proudly guaranteed against defects arising from faulty workmanship or materials for a period of seven years from the date of delivery by Wintec Systems, subject to the following:

- + The product is installed and maintained in accordance with the relevant Australian standards and recognised building practises.
- + The product has not been subject to misuse, physical abuse or neglect.
- + Only service work carried out by Wintec Systems personnel or authorised Wintec Systems agents is covered by this guarantee.
- + Claims under this guarantee should be made within one month of the defect arising in the product.

DIRECTORY

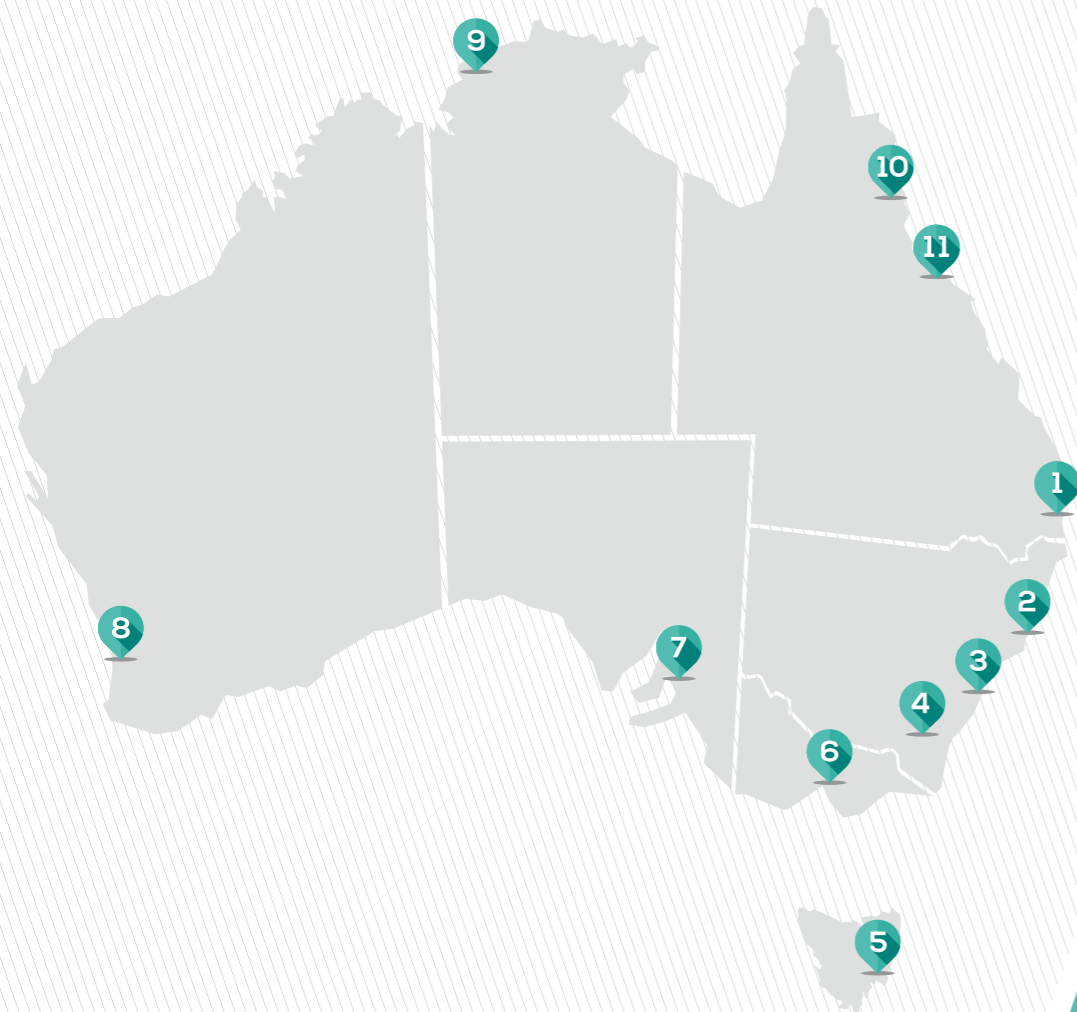

1 **BRISBANE**
20 Ron Boyle Cres, Carole Park, QLD, 4300
+61 (7) 3718 1400

2 **NEWCASTLE**
6 Steel River Blvd, Mayfield Wst, NSW, 2304
+61 (2) 4949 2600

3 **SYDNEY**
185-187 Woodpark Rd, Smithfield, NSW, 2154
+61 (2) 8787 7400

4 **CANBERRA**
12 Sawmill Cir, Hume, ACT, 2620
+61 (2) 6243 9700

5 **HOBART**
123 Albert Rd, Moonah, TAS, 7009
+61 (3) 6278 0000

6 **MELBOURNE**
893 Princess Hwy, Springvale, VIC, 3171
+61 (3) 9567 7200

7 **ADELAIDE**
57 Diagonal Rd, Pooraka, SA, 5095
+61 (8) 8300 2500

8 **PERTH**
17 King St, Bays Water, WA, 6053
+61 (8) 9473 4700

9 **DARWIN**
114 Reichardt Rd, Winnellie, NT, 0820
+61 (8) 6243 9700

10 **CAIRNS**
16 Spoto St, Woree, QLD, 4868
+61 (7) 4252 3200

11 **TOWNSVILLE**
5 Whitehouse St, Garbutt, QLD, 4814
+61 (7) 4720 7100

Wintec Systems sections are stocked throughout Ullrich branches Australia Wide.

wintec systems

SINCE OUR BEGINNING IN 1997, WE HAVE DEVELOPED A RANGE OF WINDOW AND DOOR PRODUCTS THAT ARE INNOVATIVE, FUNCTIONAL AND STYLISH.

Wintec Systems windows and doors are an all Australian designed and manufactured product, with modern designs and quality finish at the forefront of the Wintec Systems philosophy.

An ongoing commitment to product development and service to our Australia wide fabricator base ensures that no matter where you are, you have access to the latest designs in the Window and door industry.

ALUMINIUM WINDOWS & DOORS

We have products to suit all areas in Australia - consisting of: Sliding windows, Sliding doors, Awning and Casement windows, Double Hung windows, Louvres, Sliding Multi Track doors, Hinged doors and Bi-folding doors.

“ BUILDING PRODUCTS
BEYOND THE STANDARDS ”

WINDOW & DOOR TESTING LABORATORY

Our products are tested to Australian standard AS2047 in NATA accredited laboratory No 14093. This ensures your windows and doors comply with the building code of Australia [BCA] and are suited to your particular location. In line with the BCA requirements Wintec Systems windows and doors carry a 7 year guarantee.

WSPG-V1



www.wintecsystems.com.au | 07 5535 4477 | 1/34 Township Drive, Burleigh Heads, QLD, 4220



AUSTRALIAN
GLASS &
WINDOW
ASSOCIATION

